

Dash panel insert

Assignment of contacts at multi-pin connectors up to MY 99

Multi-pin connector, 32-pin, blue

Note:

Contacts which are not listed are vacant/unassigned.

- 1 - → Terminal 15
- 2 - Right turn signal
- 3 - Speedometer output 1
- 5 - Fuel gauge sender
- 6 - Airbag
- 7 - Terminal 31 (sensor earth)
- 8 - Coolant temperature
- 9 - Terminal 31 (load earth)
- 10 - Oil pressure switch
- 11 - Engine speed signal
- 12 - → Terminal 61
- 13 - Glow plug indicator
- 14 - Self-levelling suspension
- 15 - Terminal 58d
- 16 - Trailer turn signal / fault in engine electrical system
- 17 - Main beams
- 18 - Left turn signal
- 19 - ABS
- 20 - Terminal 58s
- 21 - Door contact, driver's side
- 22 - Coolant level low
- 23 - Terminal 30
- 24 - Terminal 31 (load earth)
- 25 - K wire
- 26 - Right-hand parking light
- 27 - Left-hand parking light
- 28 - Speedometer input
- 29 - Brake fluid level/pressure
- 30 - S contact
- 31 - Seat belt buckle
- 32 - ESP

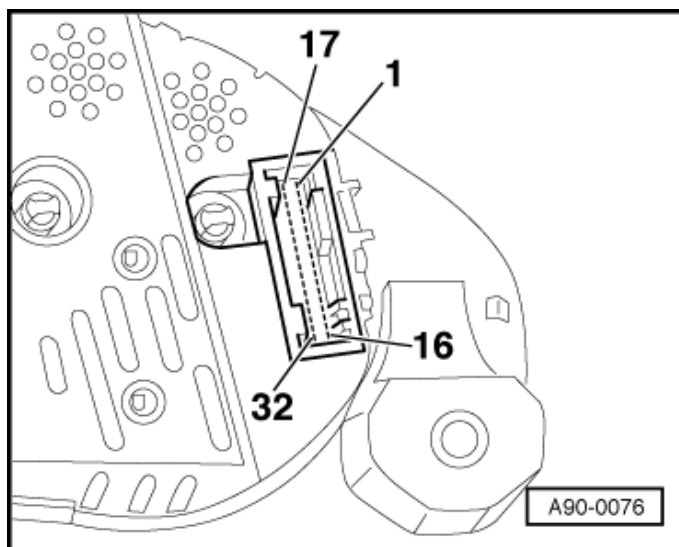

Multi-pin connector, 32-pin, green

Note:

Contacts which are not listed are vacant/unassigned.

- 2 - → Transponder 1
- 4 - Immobilizer
- 5 - W wire
- 6 - Boot lid/tailgate (Midline version only)
- 7 - Brake pads (Highline version only)
- 10 - Fuel tank warning (only on 6-cylinder TDI)
- 11 - Standing time output
- 12 - Air conditioner shut-off
- 13 - Hand brake
- 14 - Electronic throttle
- 15 - Side lights
- 17 - Transponder 2
- 21 - Oil temperature
- 29 - Terminal 58d
- 30 - Speedometer output 2

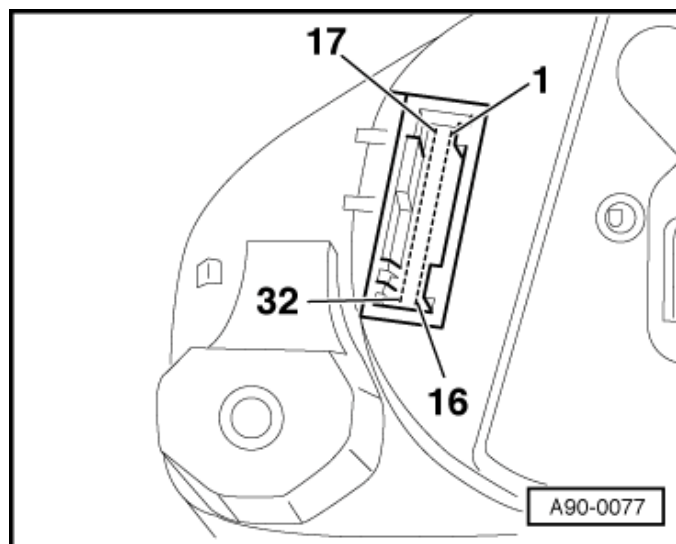

Multi-pin connector, 20-pin, red

Note:

Contacts which are not listed are vacant/unassigned.

- 1 - → Consumption signal
- 5 - Ambient temperature
- 6 - Selector lever position indicator
- 9 - Lack of washer fluid
- 10 - Hydraulic pressure
- 11 - Driver information system Reset
- 12 - Clock signal for radio frequency display
- 13 - Data signal for radio frequency display
- 14 - On-board computer, left
- 15 - Enable signal for radio frequency display
- 16 - Tail lights / dipped beams (bulb monitor)
- 17 - Glow plug relay (TDI)
- 18 - Driver information system, right
- 19 - Brake lights

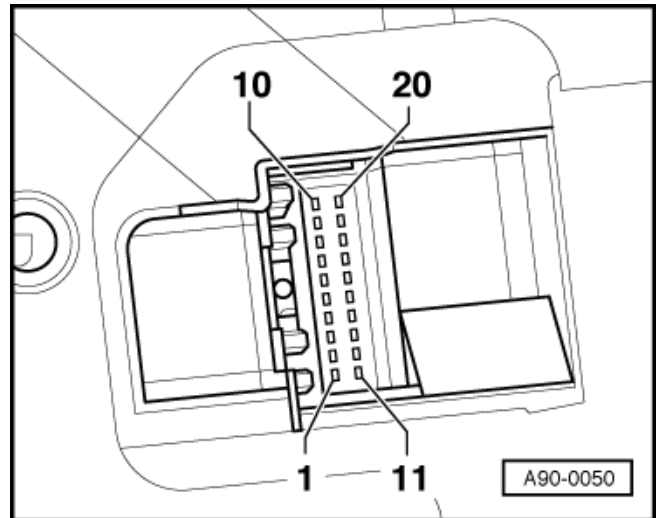

Dash panel insert

Assignment of contacts at multi-pin connectors from MY 00

Multi-pin connector, 32-pin, blue

Note:

Contacts which are not listed are vacant/unassigned.

- 1 - → Terminal 15
- 2 - Brake pad wear
- 3 - Speedometer output 1
- 5 - Fuel gauge sender
- 6 - Fuel gauge warning OBD 2
- 7 - Terminal 31 (sensor earth)
- 8 - Coolant temperature
- 9 - Terminal 31 (load earth)
- 10 - Oil pressure 2 (high)
- 11 - Engine speed signal
- 12 - Air conditioner shutoff
- 13 - Electronic throttle/ glow plug indicator
- 14 - Self-levelling suspension
- 15 - Terminal 58d
- 16 - Trailer turn signal
- → 17 - Main beams
- 18 - Left turn signal
- 20 - Terminal 58s
- 21 - Door contact, driver's side
- 22 - Low coolant level
- 23 - Terminal 30
- 24 - Terminal 31 (load earth)
- 25 - Consumption signal
- 26 - Right-hand parking light
- 27 - Left-hand parking light
- 28 - Speedometer input
- 29 - Brake
- 30 - S contact
- 31 - Speedometer output 2
- 32 - ESP/TCS

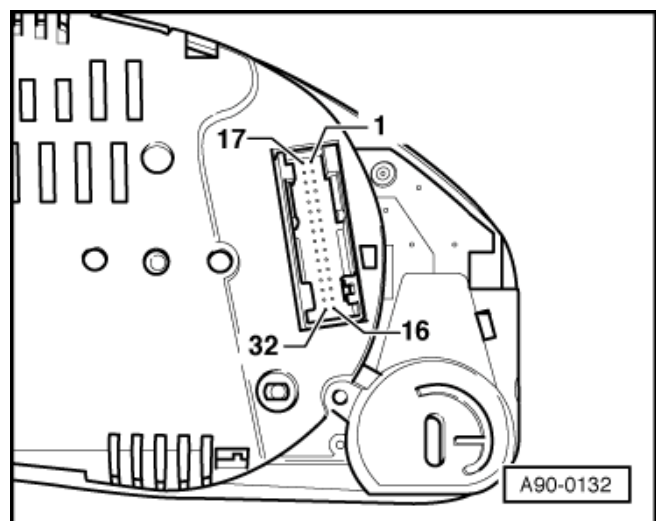

Multi-pin connector, 32-pin, green

Note:

Contacts which are not listed are vacant/unassigned.

- → 2 - Transponder 1
- 5 - W wire
- 7 - Right turn signal
- 8 - External buzzer
- 9 - External gong
- 10 - Airbag
- 11 - Standing time output
- 12 - Terminal 61
- 13 - Handbrake
- 14 - CHECK
- 15 - Oil level/temperature
- 17 - Transponder 2
- 18 - CAN-Bus High (drive train bus)
- 19 - CAN-Bus Low (drive train bus)
- 21 - ABS
- 22 - CAN-Bus High (convenience equipment bus)
- 23 - CAN-Bus Low (convenience equipment bus)
- → 25 - Bonnet
- 26 - Fuel filler cap
- 27 - Belt buckle
- 28 - K wire
- 29 - Ambient temperature input
- 30 - Terminal 58de
- 31 - Gear selector display
- 32 - Headlight range control

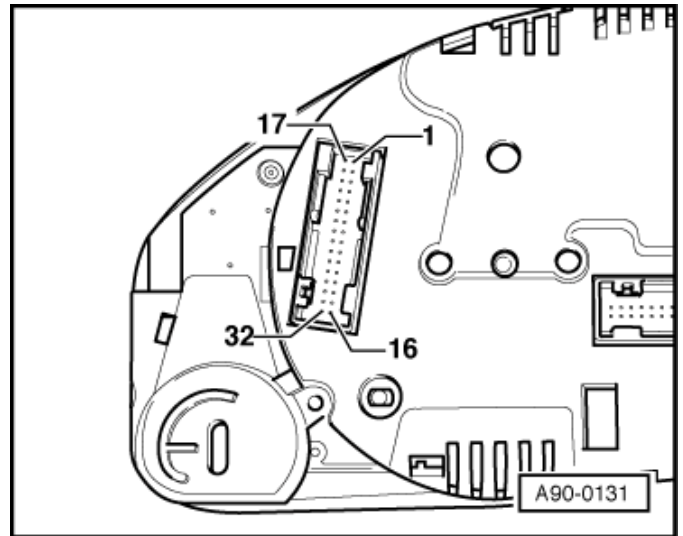

Multi-pin connector 32-pin, grey

Note:

Contacts which are not listed are vacant/unassigned.

- 1 - → Menu switch (menu)
- 2 - Menu switch (out A)
- 3 - Menu switch (out B)
- 4 - Menu switch (Enter)
- 7 - CAN-Bus High (Display)
- 12 - CAN-Bus Low (Display)
- 11 - Enable
- 12 - Clock
- 13 - Data
- 14 - Brake light
- 15 - Washer fluid level
- 16 - Tail lights / dipped beams (bulb monitor)
- 17 - On-board computer, left
- 18 - Driver information system, right
- 19 - Driver information system Reset
- 20 - Radio input, auxiliary heater
- 21 - Summer/Winter setting
- 22 - → Auxiliary heater on
- 23 - Key branch 1, Navigation system
- 24 - Key branch 2, Navigation system
- 25 - Key branch, Telematics

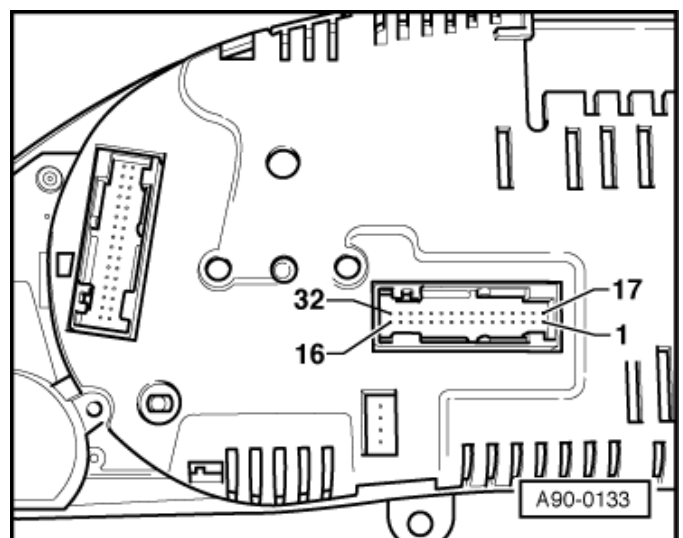

Dash panel insert

Assignment of contacts at multi-pin connectors from MY 00

Multi-pin connector, 32-pin, blue

- 1 - → Terminal 15
- 2 - Brake pad wear
- 3 - Speedometer output 1
- 5 - Fuel gauge sender
- 6 - Fuel gauge warning OBD 2
- 7 - Terminal 31 (sensor earth)
- 8 - Coolant temperature
- 9 - Terminal 31 (load earth)
- 10 - Oil pressure 2 (high)
- 11 - Engine speed signal
- 12 - Air conditioner shutoff
- 13 - Electronic throttle/ glow plug indicator
- 14 - Self-levelling suspension
- 15 - Terminal 58d
- 16 - Trailer turn signal
- → 17 - Main beams
- 18 - Left turn signal
- 20 - Terminal 58s
- 21 - Door contact, driver's side
- 22 - Low coolant level
- 23 - Terminal 30
- 24 - Terminal 31 (load earth)
- 25 - Consumption signal
- 26 - Right-hand parking light
- 27 - Left-hand parking light
- 28 - Speedometer input
- 29 - Brake
- 30 - S contact
- 31 - Speedometer output 2
- 32 - ESP/TCS

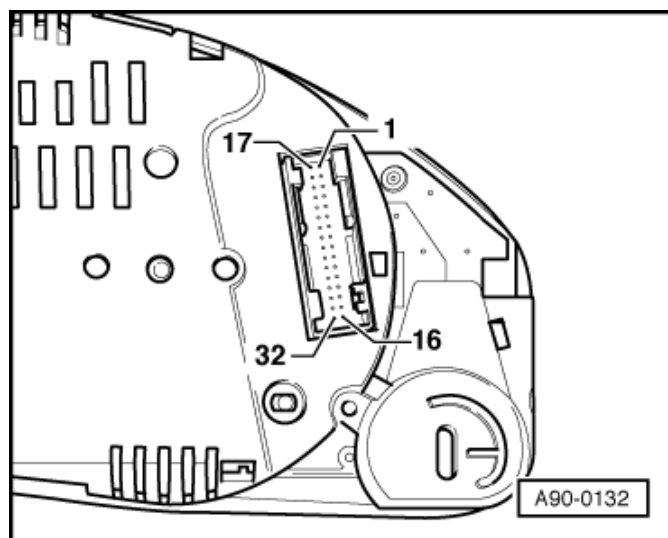

Multi-pin connector, 32-pin, green

- → 2 - Transponder 1
- 5 - W wire
- 7 - Right turn signal
- 8 - External buzzer
- 9 - External gong
- 10 - Airbag
- 11 - Standing time output
- 12 - Terminal 61
- 13 - Handbrake
- 14 - CHECK
- 15 - Oil level/temperature
- 17 - Transponder 2
- 18 - CAN-Bus High (drive train bus)
- 19 - CAN-Bus Low (drive train bus)
- 21 - ABS
- 22 - CAN-Bus High (convenience equipment bus)
- 23 - CAN-Bus Low (convenience equipment bus)
- → 25 - Bonnet
- 26 - Fuel filler cap
- 27 - Belt buckle
- 28 - K wire
- 29 - Ambient temperature input
- 30 - Terminal 58de
- 31 - Gear selector display
- 32 - Headlight range control

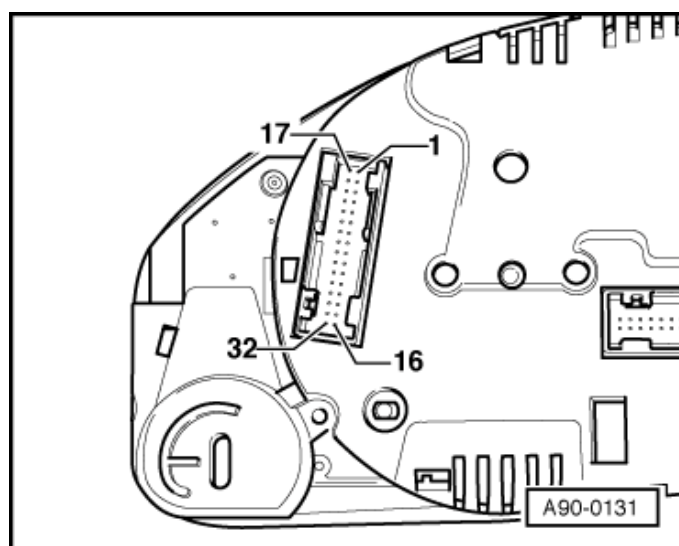

Multi-pin connector

32-pin, grey

Note:

Contacts which are not listed are vacant/unassigned.

- 1 - → Menu switch (menu)
- 2 - Menu switch (out A)
- 3 - Menu switch (out B)
- 4 - Menu switch (Enter)
- 7 - CAN-Bus High (Display)
- 12 - CAN-Bus Low (Display)
- 11 - Enable
- 12 - Clock
- 13 - Data
- 14 - Brake light
- 15 - Washer fluid level
- 16 - Tail lights / dipped beams (bulb monitor)
- 17 - On-board computer, left
- 18 - Driver information system, right
- 19 - Driver information system Reset
- 20 - Radio input, auxiliary heater
- 21 - Summer/Winter setting
- 22 - → Auxiliary heater on
- 23 - Key branch 1, Navigation system
- 24 - Key branch 2, Navigation system
- 25 - Key branch, T elematics

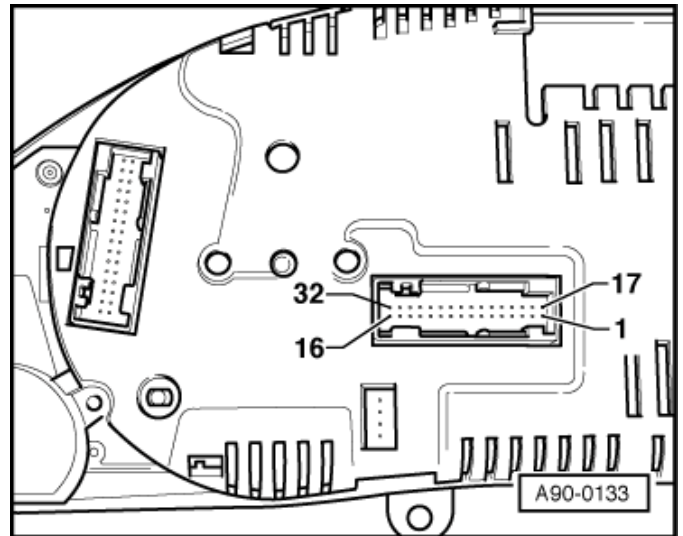

Multi-pin connector for radio-controlled clock,

4-pin, black

Note:

Contacts which are not listed are vacant/unassigned.

- 1 - Radio-controlled clock signal (data)
- 2 - Radio-controlled clock, 5V
- 4 - Radio-controlled clock, earth

